

# INSTRUCTION

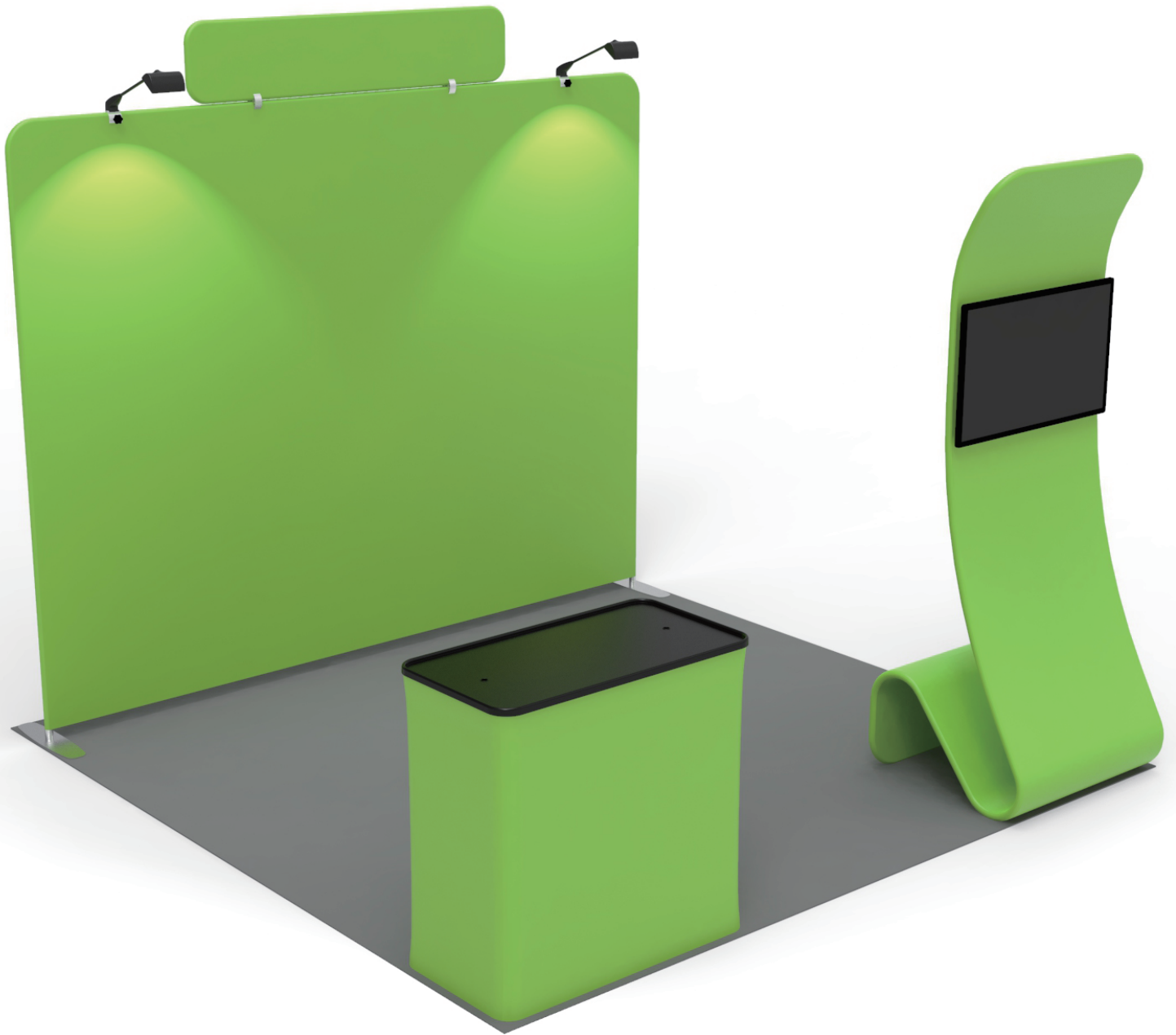

**TF-SB-10X10-25**

## STEPS

(1) Hardware

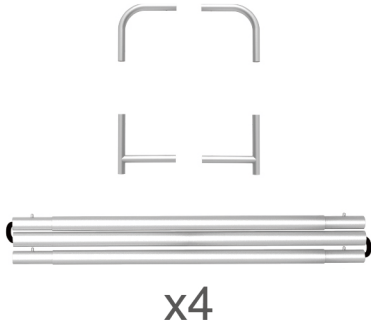

(2) Printed Graphic Fabric Banner (Optional)



### STEP 01

Connect to make long poles according to labelings.

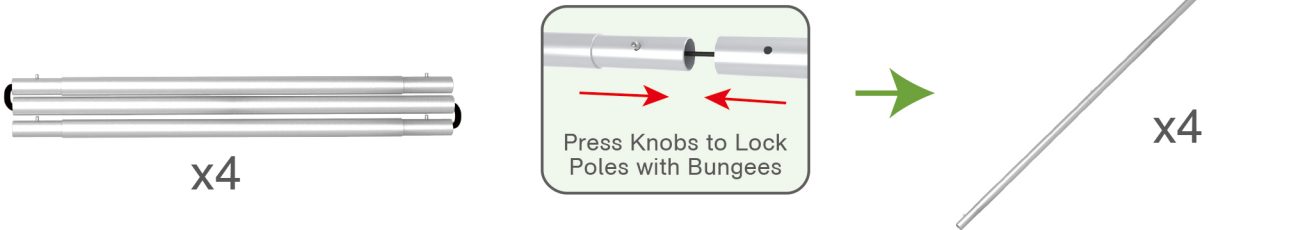

### STEP 02

Connect long poles with corner poles according to labelings.

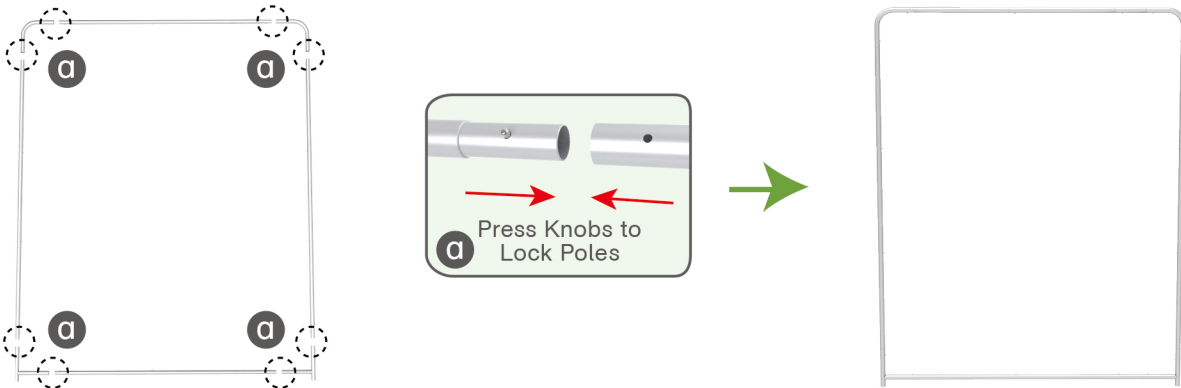

### STEP 03

Slide fabric banner on frame from top and zip up at bottom.

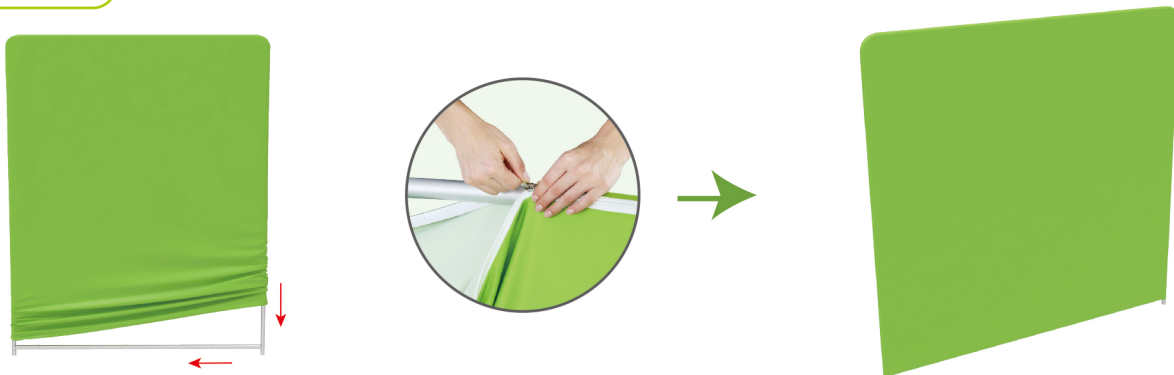

## STEPS

(1) Hardware



(2) Printed Graphic Fabric Banner (Optional)



**STEP 01** Connect poles according to labelings.

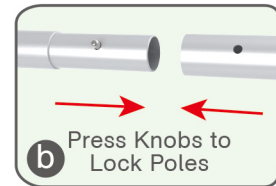
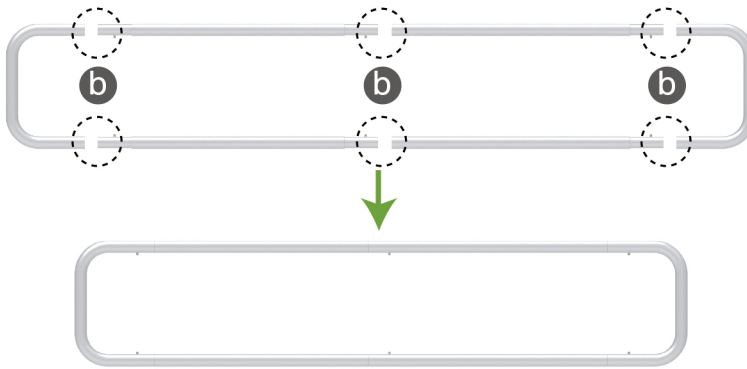

**STEP 02** Slide fabric banner on frame from left and zip up at right.

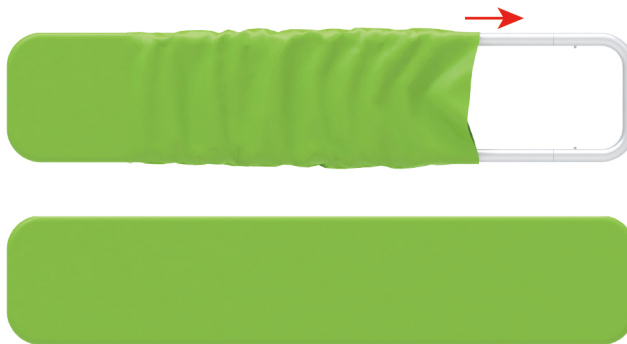

## Booth Set Assembly



(1) Base

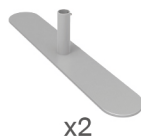

(2) LED Light & Clip



(3) 180° C-Shaped Clip

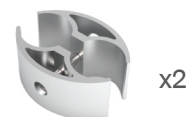

★ One Tool (Hex Wrench) 

## STEPS

**STEP 01** Interconnect display stands with C-shaped clips.

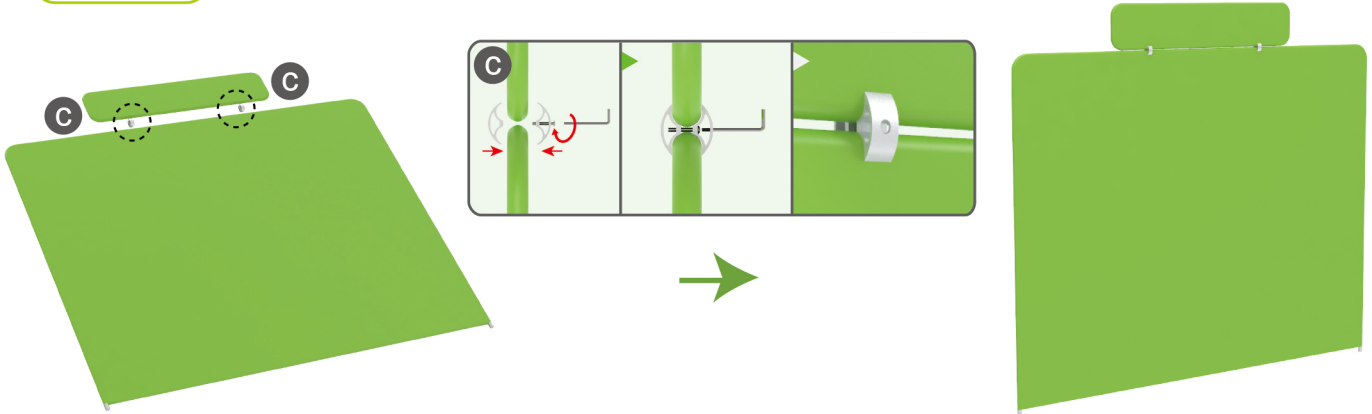

**STEP 02** Insert display stands onto feet by pressing their knobs.

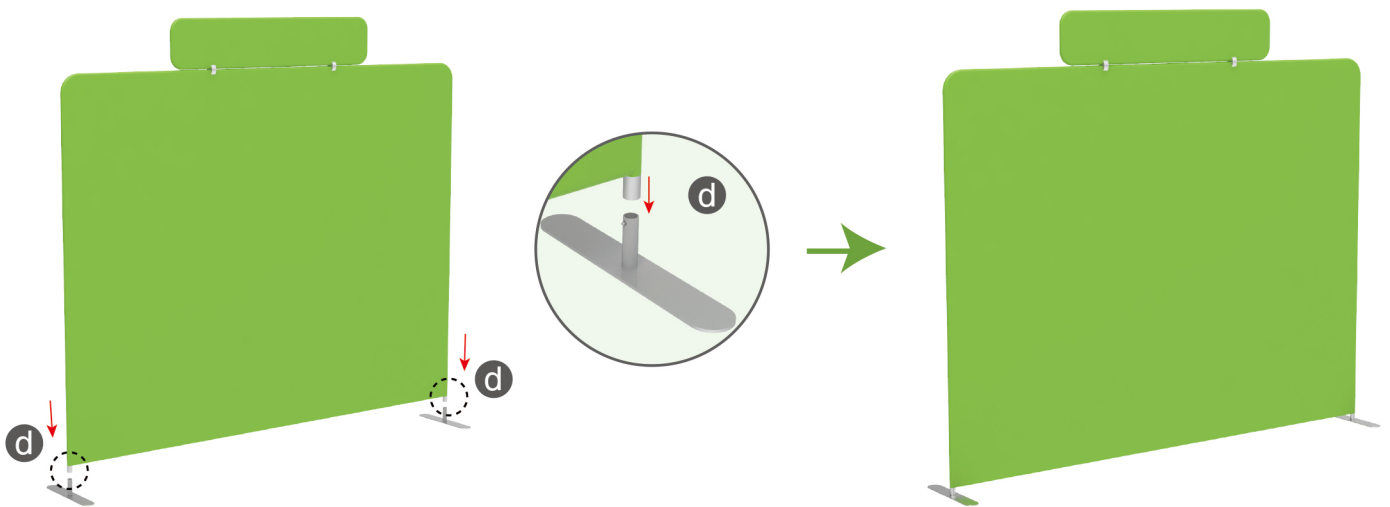

**STEP 03** Screw light clips at top of display stands, slide lights onto them and adjust their direction.

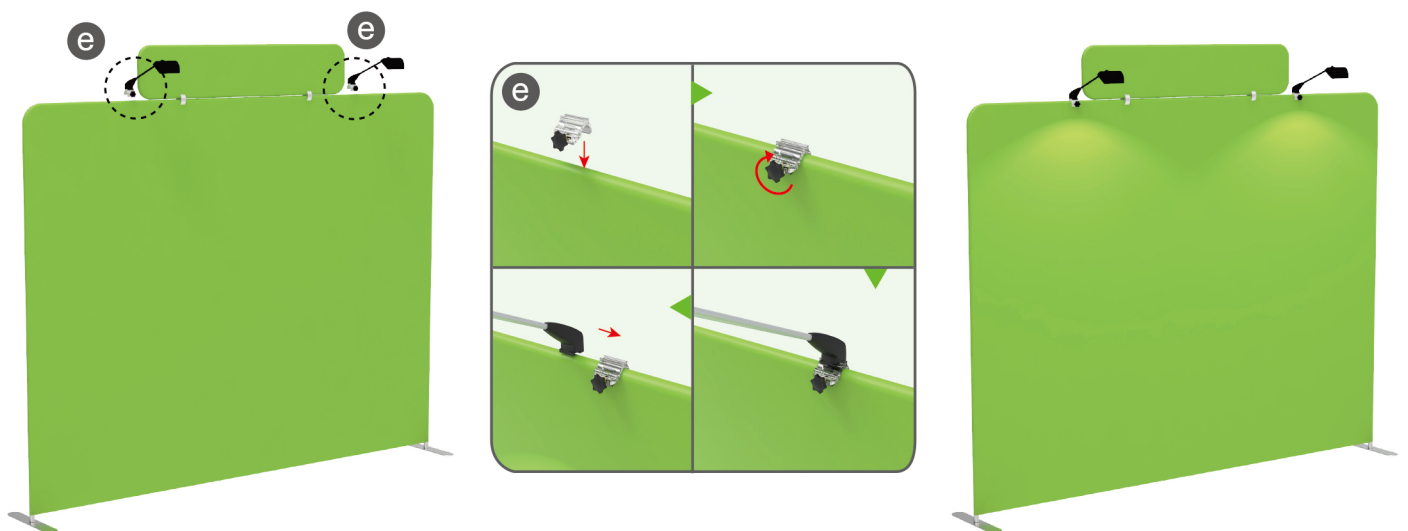



## STEPS

(1) Durable Plastic Hard Case, Aluminum Support Poles



(2) Printed Graphic Fabric Banner



### STEP 01

Put hard case's top into fabric banner.

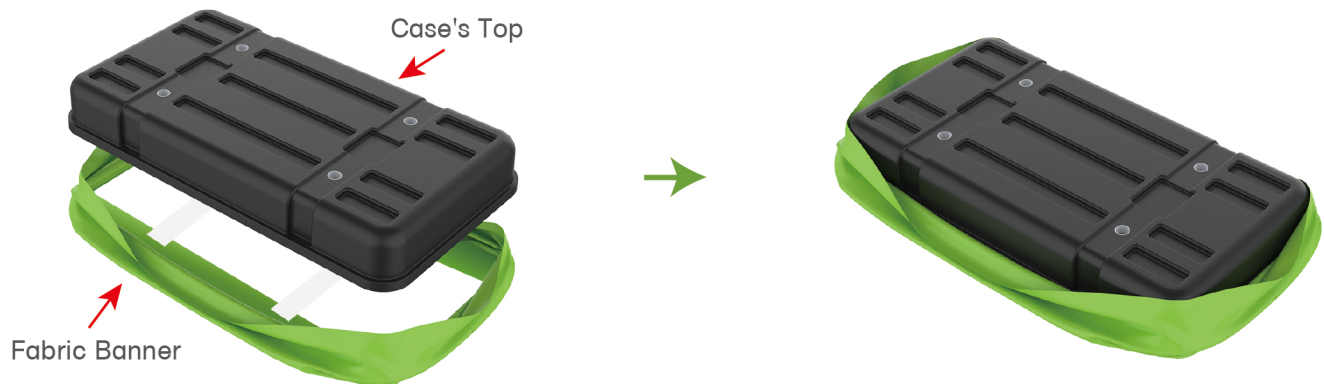

### STEP 02

Insert support poles into hard case's top & bottom.

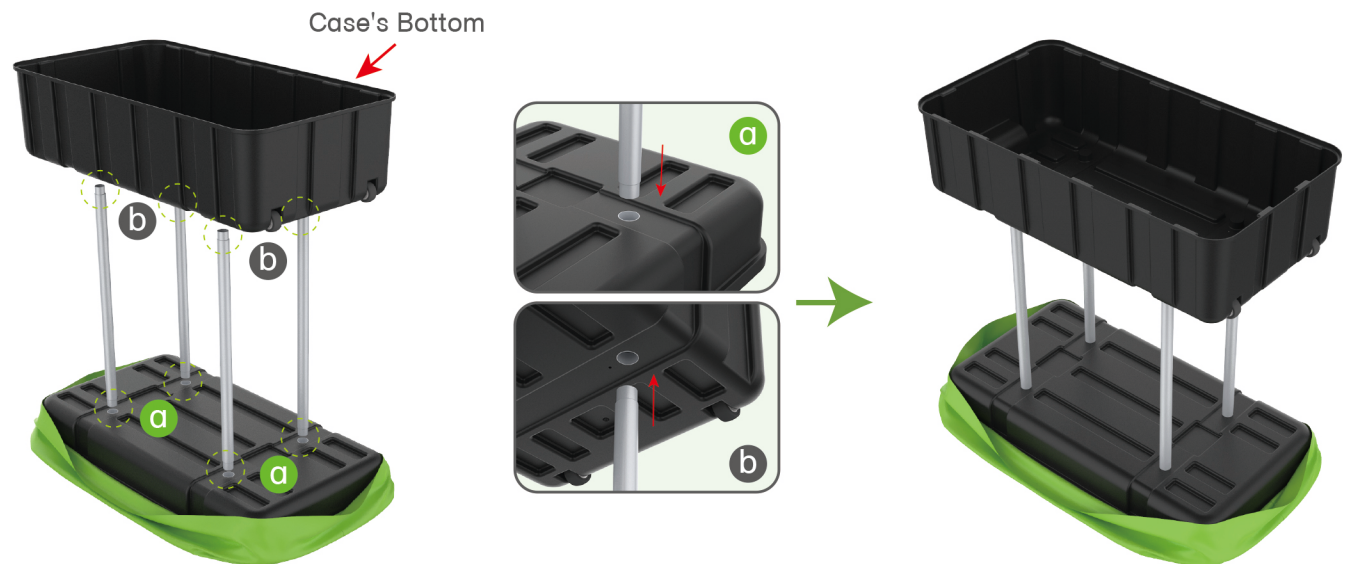

### STEPS

#### STEP 04

Wrap fabric banner from bottom to top & twist it to be smooth, lay hard case's intermediate panel on podium's top.

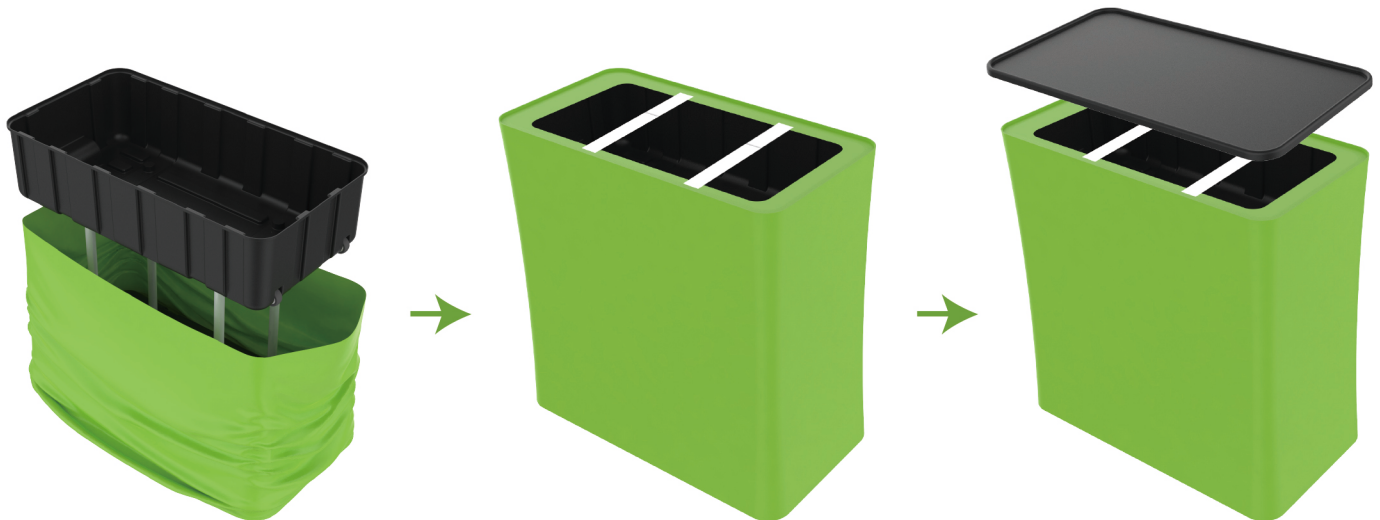

## STEPS

(1) Hardware

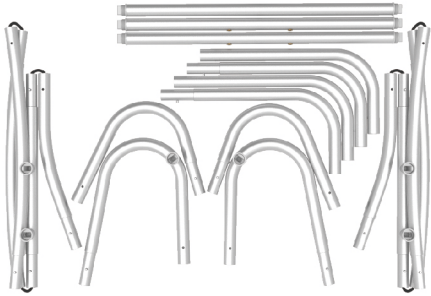

(2) Fabric banner



(3) TV mount

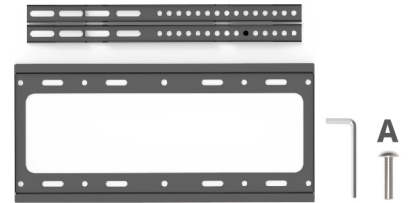

**STEP 01** To connect the poles according to the labellings

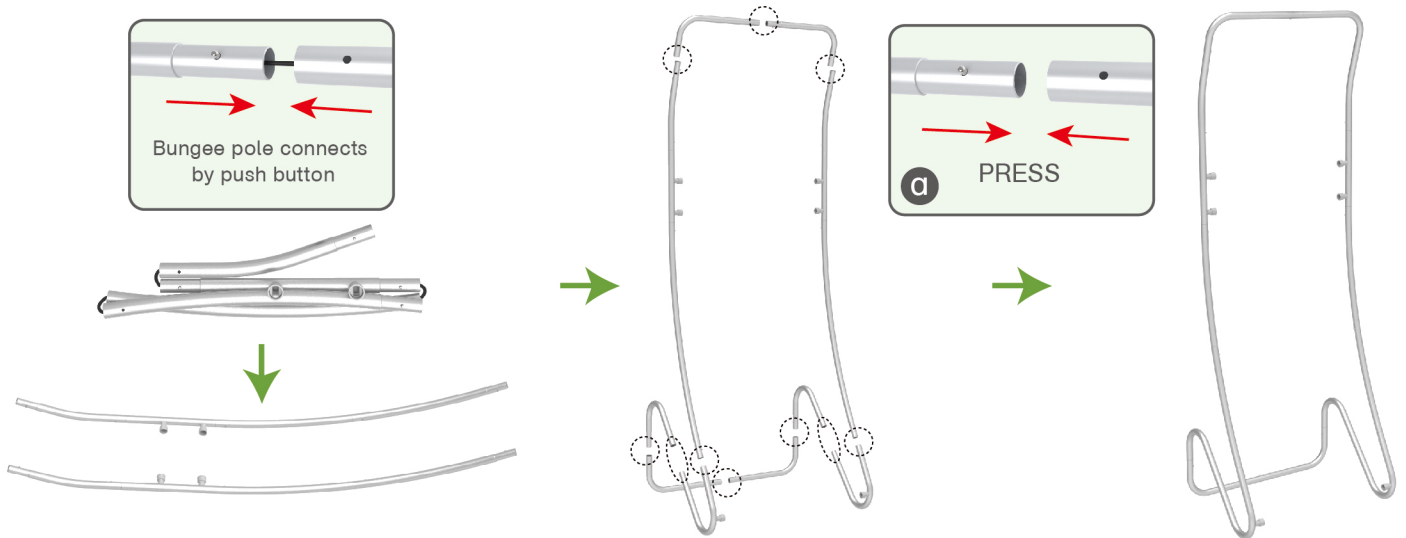

**STEP 02** To install cross bar in position

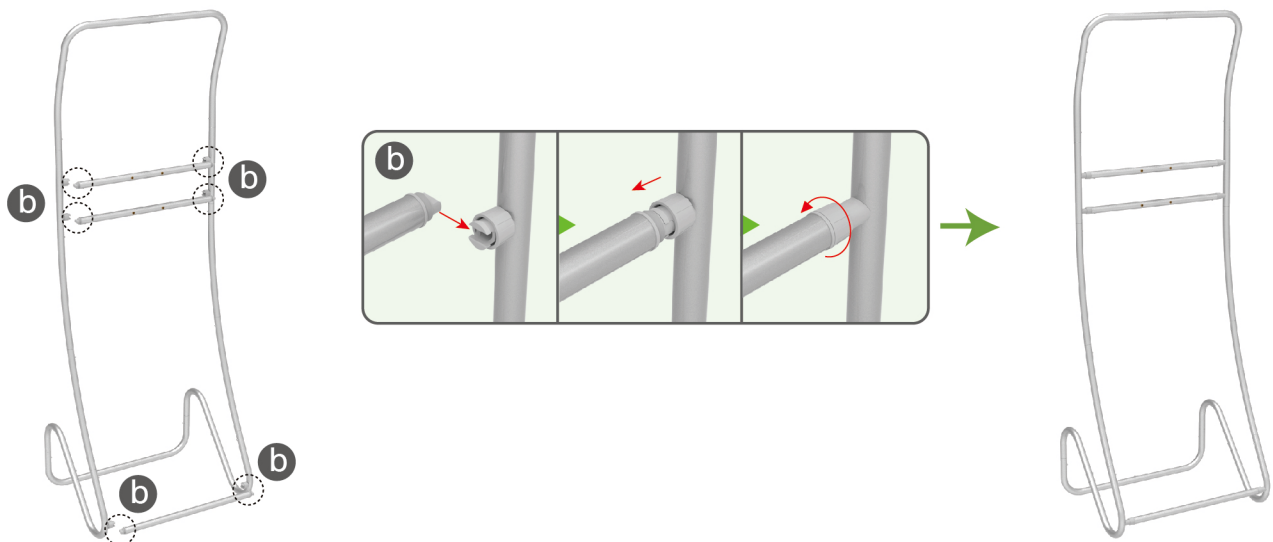

## STEPS

**STEP 03** To wrap the fabric from top to bottom and zip up

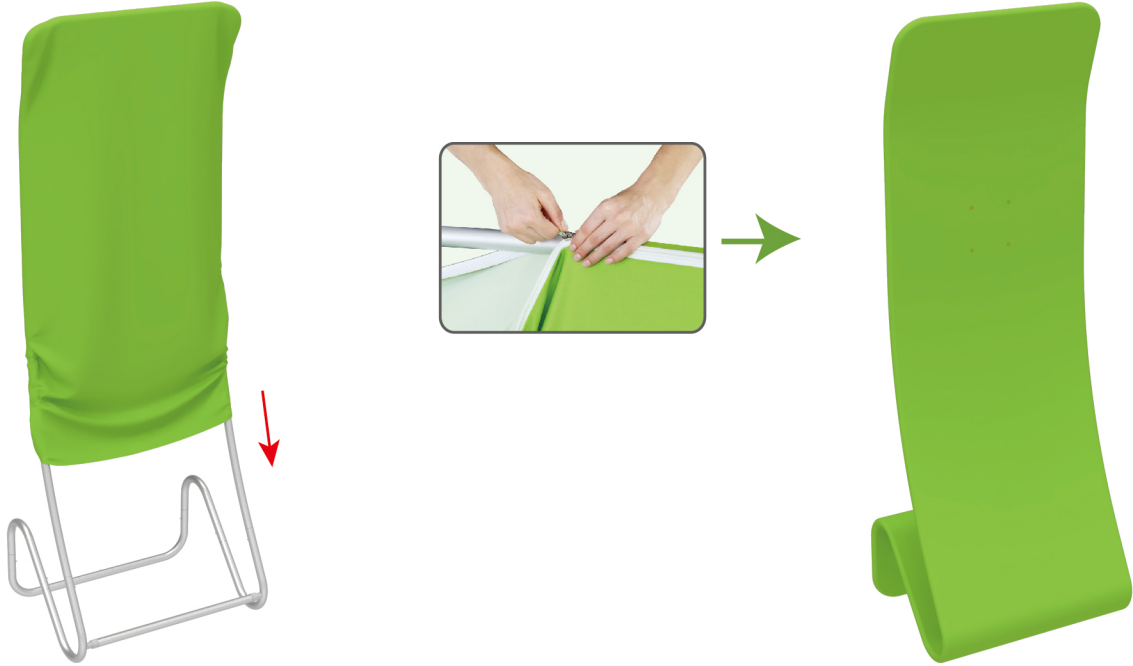

**STEP 04** To install TV in position

